

Altro Whiterock™ hygienic PVCu wall cladding to quarry tile floor detail

typical specification (Ref: WF3)

MAY 2006

Altro Whiterock hygienic PVCu wall cladding 2.5mm thick installed over most sound, dry substrates, to quarry tile skirting (typical 100mm by 12mm thick with similar

floor tiles) fixed with the appropriate AltroFix™ adhesive and double sided tape (A815) sealed with silicone sealant (A802 or A806).

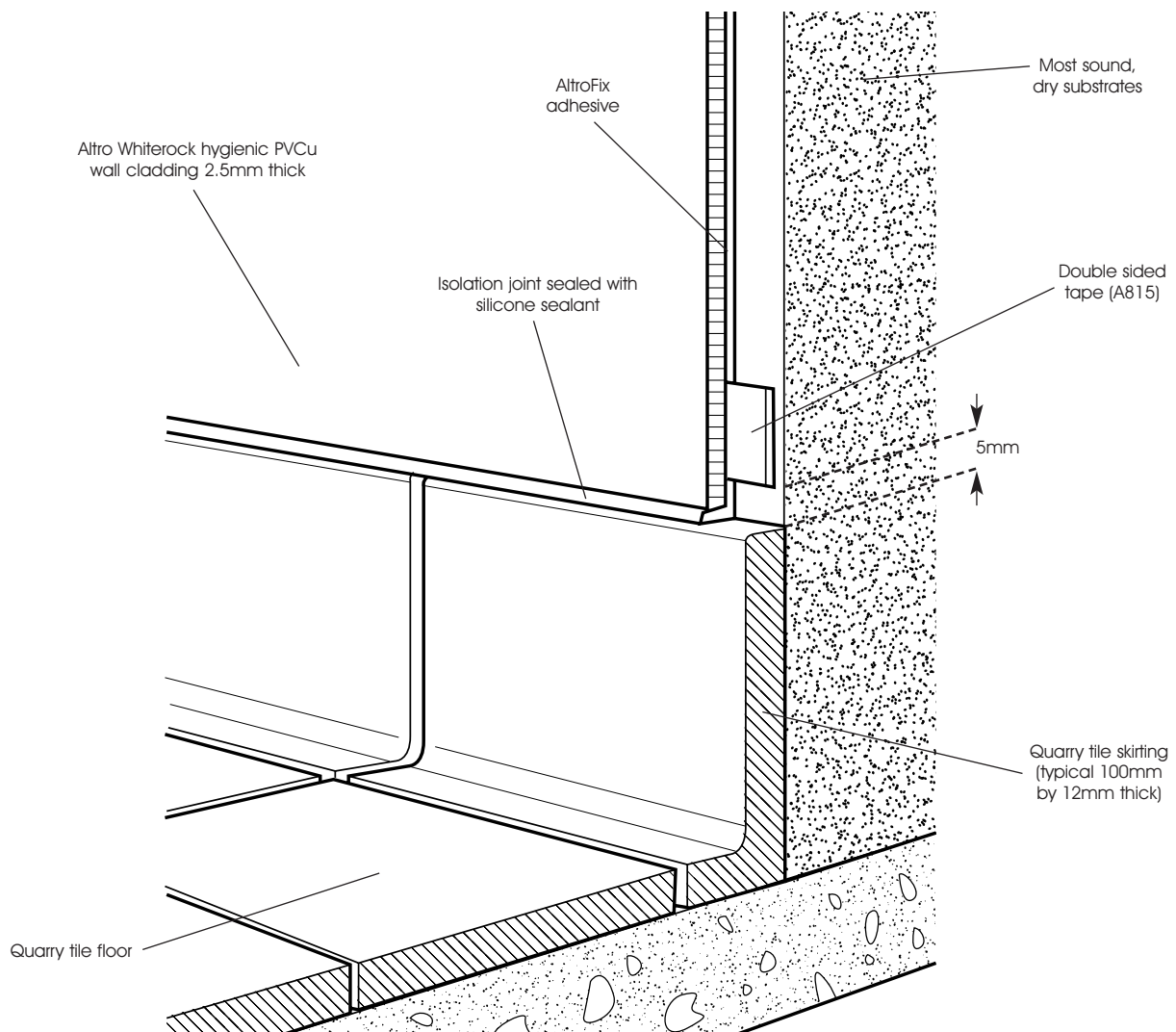

for further information or technical advice

tel: 01502 561364 fax: 01502 531461

e-mail walls@altro.com or explore www.altro.com