

# Altro Whiterock™ hygienic PVCu wall cladding to boxing inspection cover detail

MAY 2006

typical specification (Ref: W3)

Altro Whiterock hygienic PVCu wall cladding 2.5mm thick to boxing/inspection cover with thermoformed corners, using Altro transition strip (A832/25) over

tanalised timber framework and 9mm WPB plywood cladding screwed to framework, fixed with AltroFix™ adhesive to plywood.

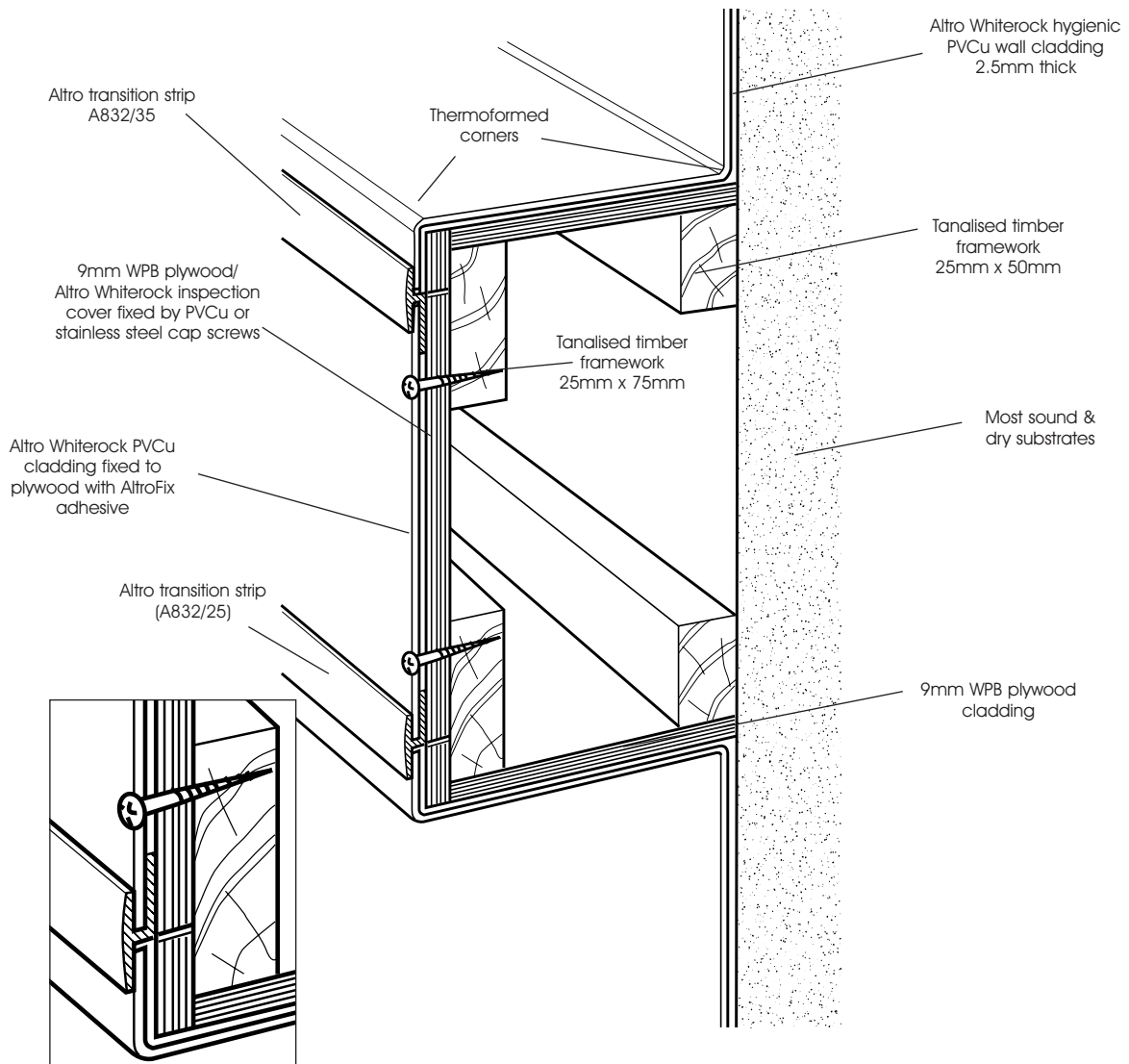

for further information or technical advice

tel: 01502 561364 fax: 01502 531461

e-mail [walls@altro.com](mailto:walls@altro.com) or explore [www.altro.com](http://www.altro.com)